



# COARSE GRAIN ANALYZER

## Quality Control and Composition



- *Rapid & non-destructive inspection of coarse grains, beans, and oilseeds*
- *Optimize processing & extraction and monitor quality of end products*
- *Measure protein, fat, moisture, fiber, and much more*

Our portable Coarse Grain, Bean, and Oilseed Analyzer can help improve consistency & efficiency of many processing and extraction applications as well as provide rapid on-site analysis during bulk trading to ensure product grade.

The ChemWiz-ADK-CGBO and ChemWiz-ADK-Case-CGBO (for Coarse Grains, Beans, and Oilseed) includes research-grade spectrometer instrumentation in either a handheld modular set-up or mounted in a portable and rugged case.

With a simple press of the "Analyze" button instantaneous match results or sample % composition can be displayed on your screen.

**ChemWiz-ADK-CGBO and ChemWiz-ADK-Case-CGBO**  
(Coarse Grains, Beans, Oilseed)



Simple user interface with %Fat, Fiber, Protein, & Moisture Displayed

### Starter Packages for Sunflower Seeds

Included with your system is our starter calibration for fat, fiber, protein and moisture in Sunflower seeds. The calibration was generated using over a 100 different samples varying in composition. Custom calibrations can be easily developed with our SMART-NIRS calibration packages!



# OILSEED APPLICATIONS

- Optimize the oil extraction process
- Increase the production yield
- Minimize energy and solvents
- Analyzes protein concentrates

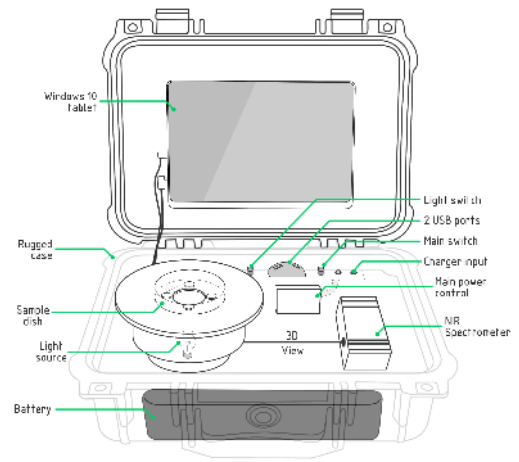

## SPECIFICATIONS

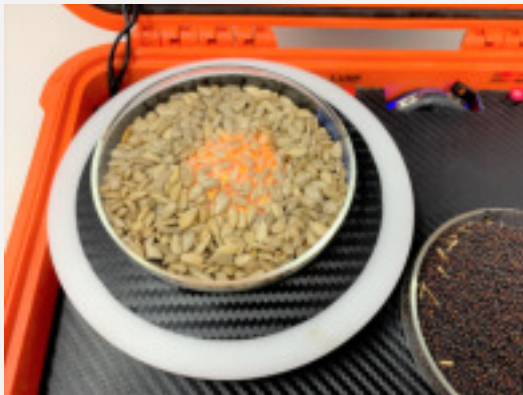

<b>Spectrometer Range:</b>	900-1700nm
<b>Optical Resolution:</b>	2.5nm
<b>Detector Type:</b>	InGaAs Photodiode array
<b>Reflectance Source:</b>	Tungsten Halogen
<b>Optical Measurement:</b>	3D reflectance, probe, or industrial fixture 8hr
<b>Battery:</b>	lithium ion
<b>Lamp Power In:</b>	350 mA @ 12 VDC
<b>Dimensions:</b>	Handheld 1.5 x 11 x 6.5"   Case: 6 x 11 x 13"
<b>Measurement Speed:</b>	Typical 1-5 seconds
<b>Tablet Specs:</b>	Android
<b>Software Included:</b>	ChemWiz-ADK PRO
<b>Starter Calibrations Included:</b>	CGBO - sunflower seed, flax seed, soy, and rapeseed starter calibrations



+1-813-855-8687

[www.StellarNet.us/Analyzers](http://www.StellarNet.us/Analyzers)